

R66 SERVICE LETTER SL-28

DATE: 05 November 2018

TO: R66-series Owners, Operators, & Maintenance Personnel

SUBJECT: Main Rotor Gearbox Internal Visual Inspection

BACKGROUND: RHC recommends an internal visual inspection of the main rotor gearbox (MRGB) annually per the procedure below (may be coincident with aircraft annual inspection). Inspection is prompted by observations of internal corrosion beginning to form on some units returned to the factory for repair or overhaul. Corrosion is more likely on helicopters which are operated infrequently. Visual inspection will be included in R66 Maintenance Manual Table 1, Scheduled Inspections at the next revision.

COMPLIANCE PROCEDURE:

1. Refer to Figure 1. Gain access to and remove MRGB filler plug.
2. Via filler plug hole and using borescope, miniature camera, or smartphone camera with flash, visually inspect specified area of gear carrier. Rotate gearbox by hand-turning main or tail rotor as required to view entire circumference.
3. If no corrosion is evident, install filler plug and special torque per MM § 20-33.
4. If corrosion is detected, contact [RHC Technical Support](#).
5. Make appropriate maintenance record entries.

(OVER)

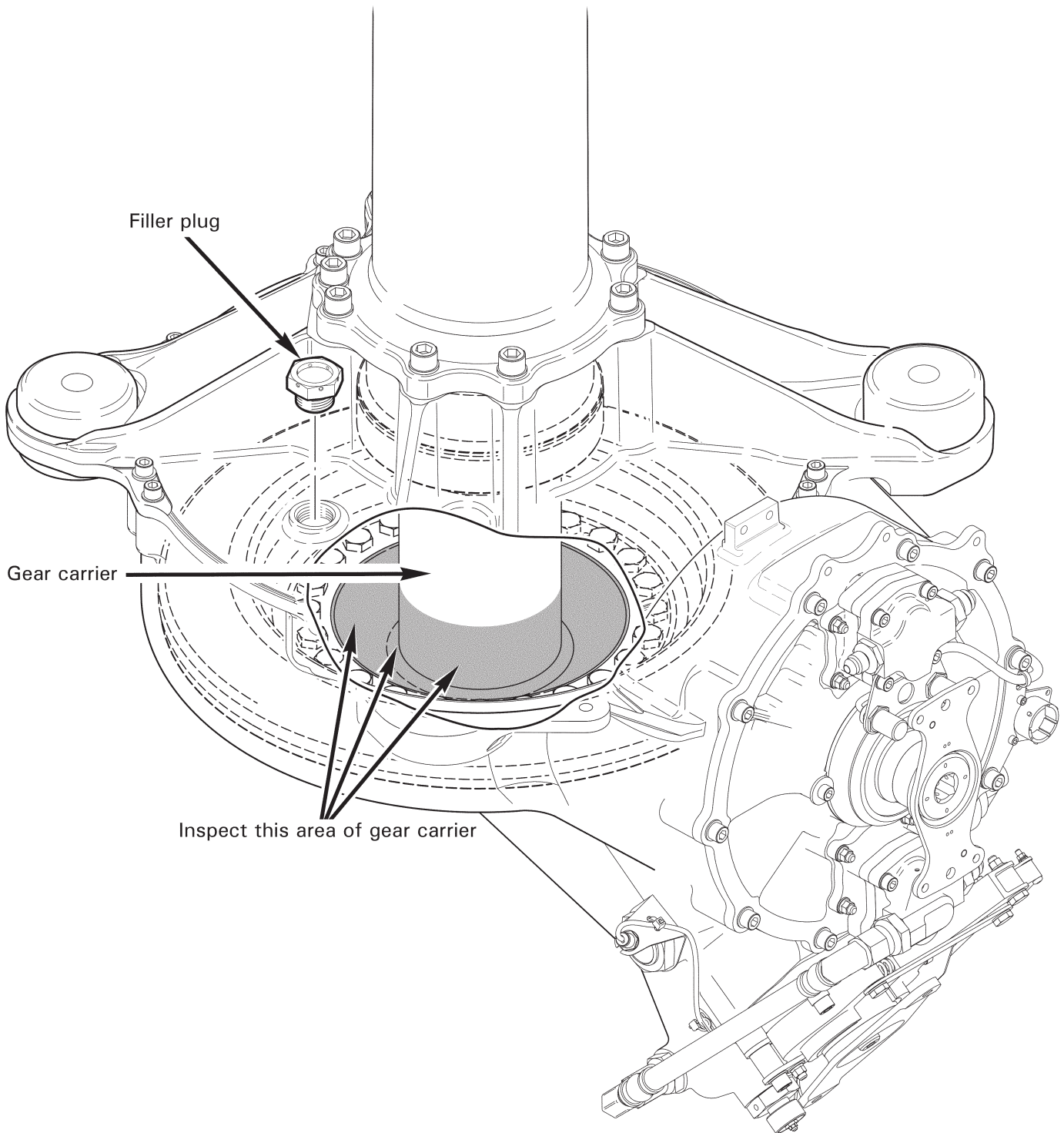

FIGURE 1