

R66-series Lithium-Ion Battery Installation Upgrade Kit Instructions
(To comply with R66 Service Letter SL-27)

NOTE

Visit www.robinsonheli.com to verify kit instructions are current revision. Review instructions before installation; contact RHC Technical Support with questions. Verify kit contents match list; contact RHC Customer Service if parts are missing or damaged.

ITEM	PART NUMBER	KIT CONTENTS	QTY
1	KI-247-3 Instr.	Kit Instructions	1
2	B304-19	Capacitor Assembly	1
3	MS3367-4-9+	Ty-rap (Note: "+" in contents part number indicates 20-qty pack)	1
4	MS3367-7-9+	Ty-rap (Note: "+" in contents part number indicates 10-qty pack)	1

Kit Instructions

1. Disconnect battery ground (NEG) cable at battery per R66 Maintenance Manual (MM) § 96-12 B. 1 thru 6.
2. Remove aft-left backrest assembly per MM § 25-22.
3. Refer to Figure 1. Remove hardware securing clamp on battery power cable to G130-7 angle, leaving clamp on cable. Remove finish from angle at clamp installation point to ensure electrical ground (rotate clamp if necessary for access to angle). Attach clamp and -2997 wire terminal (of B304-19 capacitor assembly) to angle with hardware as shown in Detail A; verify security.
4. Access battery relay inboard stud terminal, remove nut and washer. Install -2996 wire terminal (of B304-19 capacitor assembly) and position as shown in Figure 1. Install retained washer and terminal nut. Special torque nut to 80 in.-lb. Verify security. Torque stripe per MM Figure 5-1. Position nipple over stud terminal.

CAUTION

Do not overtorque terminal nut. Damage may occur to stud terminal.

5. Secure capacitor assembly to wire bundle using (2) MS3367-7-9 ty-raps. Secure -2996 wire to nipple, and -2997 wire to battery power cable using (1) MS3367-4-9 ty-rap at each location. Cinch ty-raps until snug (**do not overtighten**) and trim tips flush with heads.

CAUTION

Do not overtighten ty-raps securing B304-19 capacitor assembly to battery power cable. Damage to capacitor may result.

6. Install aft left backrest assembly per MM § 25-22.

Kit Instructions (continued)

- 7. Verify battery switch is off and battery (NEG) ground terminal is clean. Connect battery ground cable at battery per MM § 96-12 C. 7 & 8.
- 8. Install auxiliary fuel tank per MM § 28-51, if removed and required.
- 9. Make appropriate maintenance record entries. No change to Weight and Balance Record is required.

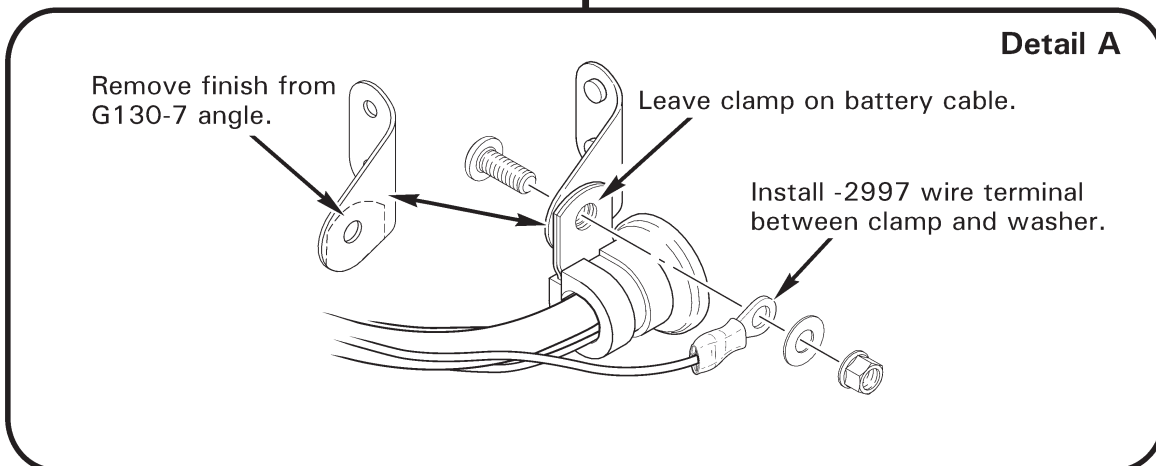
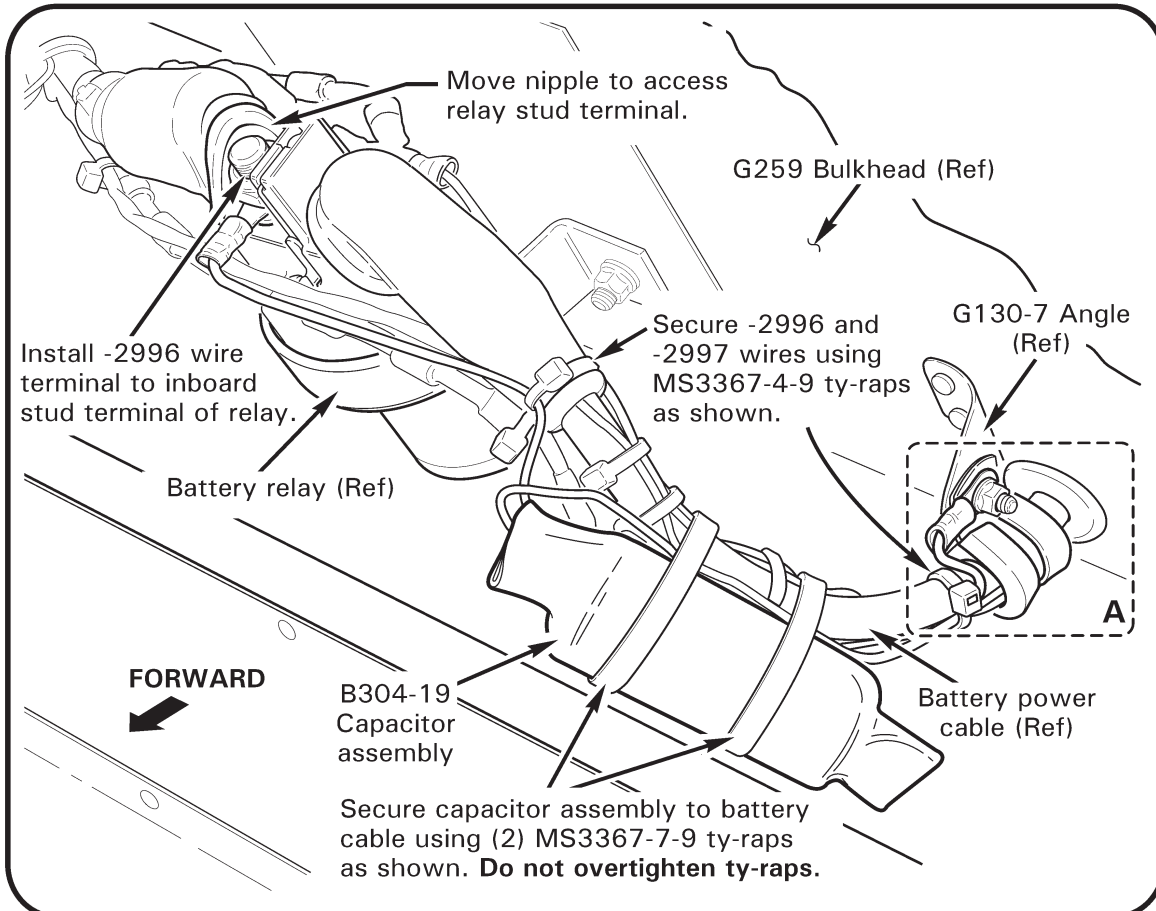

FIGURE 1
(view looking down & inboard)