

CHAPTER 8  
WEIGHT AND BALANCE

| <i>Figure</i> | <i>Title</i>                   | <i>Page</i> |
|---------------|--------------------------------|-------------|
| 8-1           | Ballast Installation . . . . . | 8.0         |

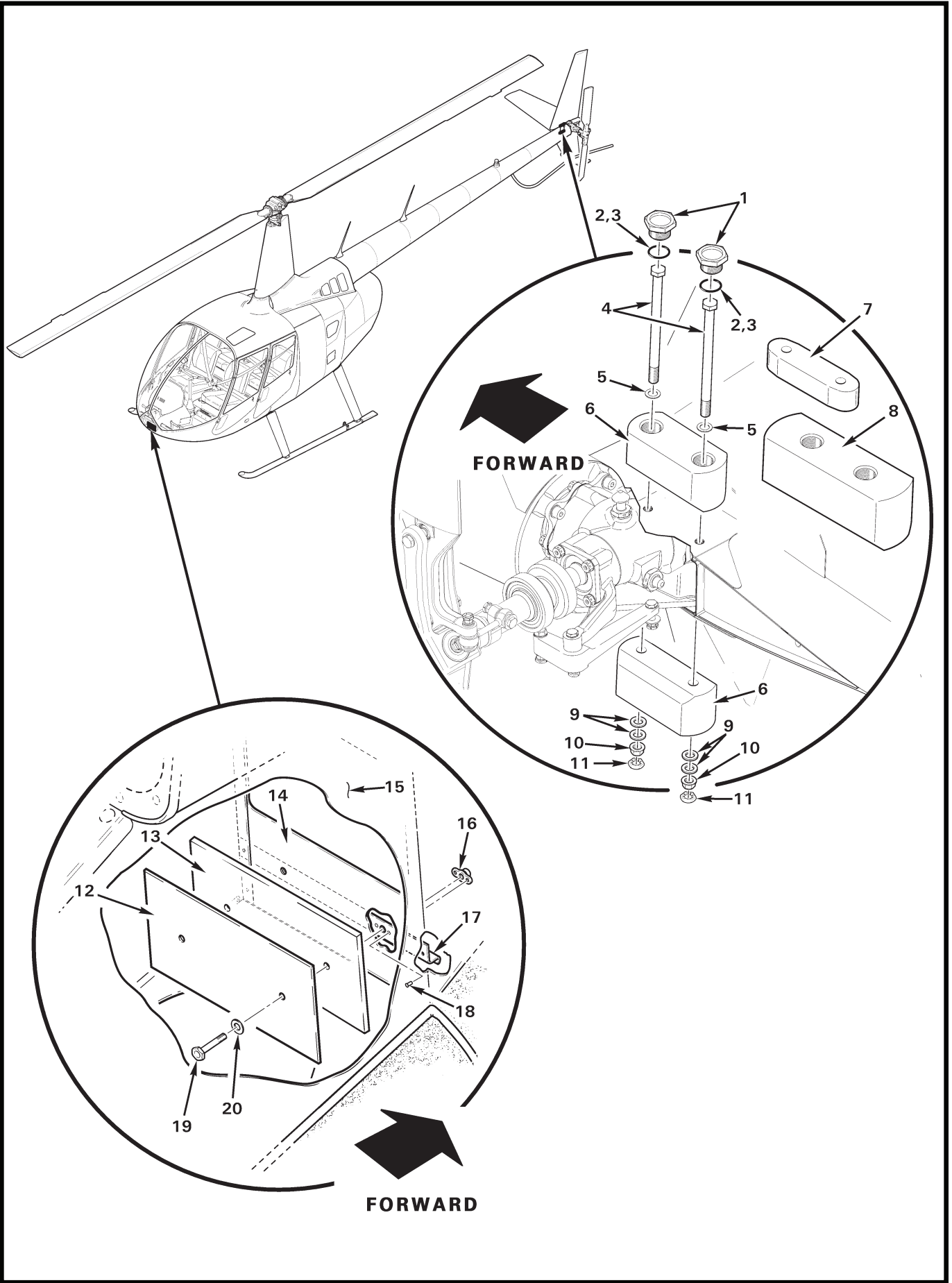

| FIGURE AND INDEX NUMBER     | PART NUMBER   | DESCRIPTION   | PARTS AVAIL | QTY PER ASSY |
|-----------------------------|---------------|---|-------------|--------------|
| <b>BALLAST INSTALLATION</b> |               |   |             |              |
| 8-1-1                       | AN814-10D     | Plug . . . . .  | X           | 2            |
| 2                           | A215-018      | O-ring (install using item 3) . . . . .   | X           | 2            |
| 3                           | A257-18       | Lube – O-ring . . . . .   | X           | A/R          |
| 4                           | NAS6606-78    | Bolt . . . . .  | X           | 2            |
| 5                           | NAS1149F0632P | Washer . . . . .  | X           | 2            |
| 6                           | D301-4*       | Weight (4.5 lb; cap using items 1, 2 and 3 when in the top position) . . . . .      | X           | A/R          |
| 7                           | D301-2*       | Weight (1.5 lb; no cap required in the top position) . . . . .                      | X           | A/R          |
| 8                           | D301-8*       | Weight (10.5 lb; cap using items 1, 2, and 3 when in the top position) . . . . .    | X           | A/R          |
| 9                           | NAS1149F0663P | Washer ([1] or [2] under each nut as required for 1 to 4 threads exposed) . . . . . | X           | A/R          |
| 10                          | D210-6        | Nut . . . . .   | X           | 2            |
| 11                          | B330-19       | Palnut . . . . .  | X           | 2            |
| 12                          | A941-5*       | Ballast Plate (0.25 lb) . . . . .   | X           | A/R          |
| 13                          | A941-6*       | Ballast Plate (1.25 lb) . . . . .   | X           | A/R          |
| 14                          | F361          | Console Panel (Ref)   |             |              |
| 15                          | F033          | Console Assembly (Ref)  |             |              |
| 16                          | MS21069L3     | Nutplate . . . . .  | X           | 2            |
| 17                          | C360-2        | Stiffener (Ref)   |             |              |
| 18                          | NAS1097AD3    | Rivet . . . . .   | X           | 4            |
| 19                          | NAS6603**     | Bolt (alternate part no. NAS428-3A**) . . . . .                                     | X           | 2            |
| 20                          | NAS1149F0332P | Washer . . . . .  | X           | 2            |
| * * *                       |               |   |             |              |
| 21                          | KI-174        | Empennage Ballast Installation Kit (Incl items 4, 5, 7, 9 [4] thru 11) . . . . .    | X           | 1            |

NOTES \* Refer to R66 Maintenance Manual (MM) Chapter 8 for ballast limitations.  
 \*\* Select bolt length to meet torque requirements per R66 MM Section 20-30.

Intentionally Blank