

CHAPTER 8
WEIGHT AND BALANCE

<i>Figure</i>	<i>Title</i>	<i>Page</i>
8-1	Ballast Installation	8.0

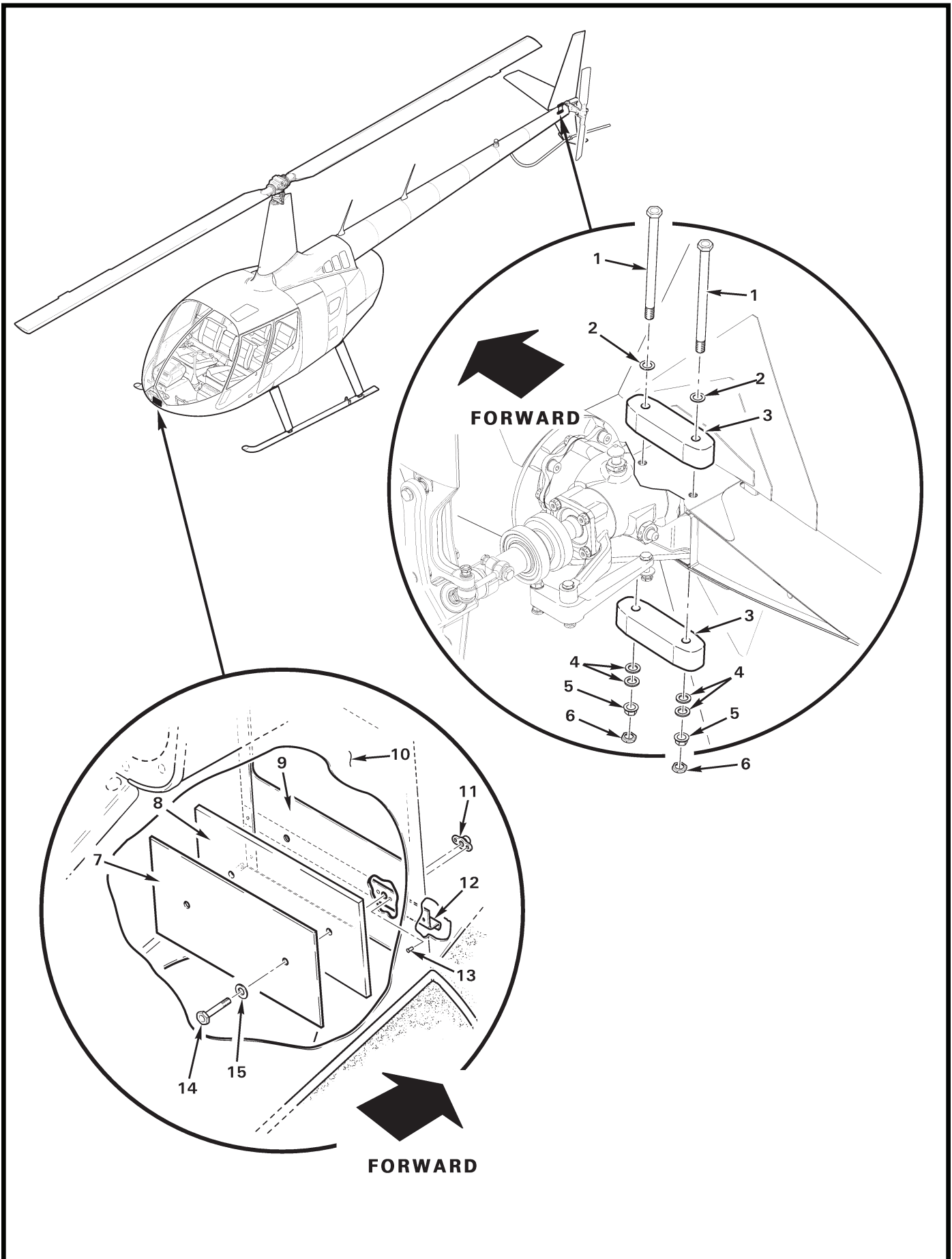

FIGURE AND INDEX NUMBER	PART NUMBER	DESCRIPTION	PARTS AVAIL	QTY PER ASSY
BALLAST INSTALLATION				
8-1-1	NAS6606-78	Bolt	X	2
2	NAS1149F0632P	Washer	X	2
3	D301-2*	Weight	X	2
4	NAS1149F0663P	Washer ([1] or [2] under each nut as required)	X	A/R
5	D210-6	Nut	X	2
6	B330-19	Palnut	X	2
7	A941-5*	Ballast Plate (0.25 lb)	X	A/R
8	A941-6*	Ballast Plate (1.25 lb)	X	A/R
9	F361	Console Panel (Ref)		
10	F033	Console Assembly (Ref)		
11	MS21069L3	Nutplate	X	2
12	C360-2	Stiffener (Ref)		
13	NAS1097AD3	Rivet	X	4
14	NAS6603**	Bolt (alternate part no. NAS428-3A**)	X	2
15	NAS1149F0332P	Washer	X	2
* * *				
16	KI-174	Empennage Ballast Installation Kit (Incl items 1 thru 3, 4 [2], 5, and 6)	X	1

NOTES * Refer to R66 Maintenance Manual (MM) Chapter 8 for ballast limitations.
 ** Select bolt length to meet torque requirements per R66 MM Section 20-30.

Intentionally Blank