

ROBINSON HELICOPTER COMPANY

2901 Airport Drive, Torrance, California 90505

■ PHONE (310) 539-0508 ■ FAX (310) 539-5198

R44

Page 1 of 2

SERVICE BULLETIN #1A

DATE: 24 May 1994 Rev 26 May 1994

TO: R44 Owners and Operators

SUBJECT: Required modification of cyclic trim motors

ROTORCRAFT AFFECTED: R44 Helicopter S/N's 0006 thru 0070

TIME OF COMPLIANCE: Within the next 10 flight hours

BACKGROUND: Failure of the cyclic trim motor drive has occurred in one or more aircraft. To prevent any future failures, both the longitudinal and the lateral trim motors must be returned to RHC for modification.

COMPLIANCE PROCEDURE:

- 1) Disconnect longitudinal elastic cords per R44 Maintenance Manual Section 8.131. Remove C055-2 and C055-6 cyclic trim assembly from the cyclic control assembly per Sections 8.141 and 8.143.
- 2) Disconnect the lateral cyclic trim spring assembly from the arm of the C055-2 cyclic trim assembly by removing the B330-13 palnut and the AN316-4R nut. Slide the shaft out of the arm and retain spring assembly in your possession. With the spring assembly removed, the motor assembly becomes a C055-8.
- 3) Return C055-8 (C055-2 less spring assembly) and C055-6 to RHC with a Component Return Authorization form. RHC will perform the modification and send parts back out within two working days.
- 4) Mount lateral cyclic trim spring assembly to arm of C055-8 cyclic trim assembly when parts are received back from RHC, making it a C055-2 assembly. (Torque AN316-4R nut onto shaft by hand, then torque B330-13 palnut against AN316-4R nut to 20 in-lbs).
- 5) Install C055-2 and C055-6 in aircraft per Maintenance Manual Sections 8.142 and 8.144. Reference page 2 of this Service Bulletin for location of spacers on longitudinal trim motor.
- 6) Connect longitudinal elastic cords per Maintenance Manual Section 8.132.

Approximate Cost:

Labor: 3 manhours

Material: No charge

TECHNICAL REQUIREMENTS FAA APPROVED

(OVER)

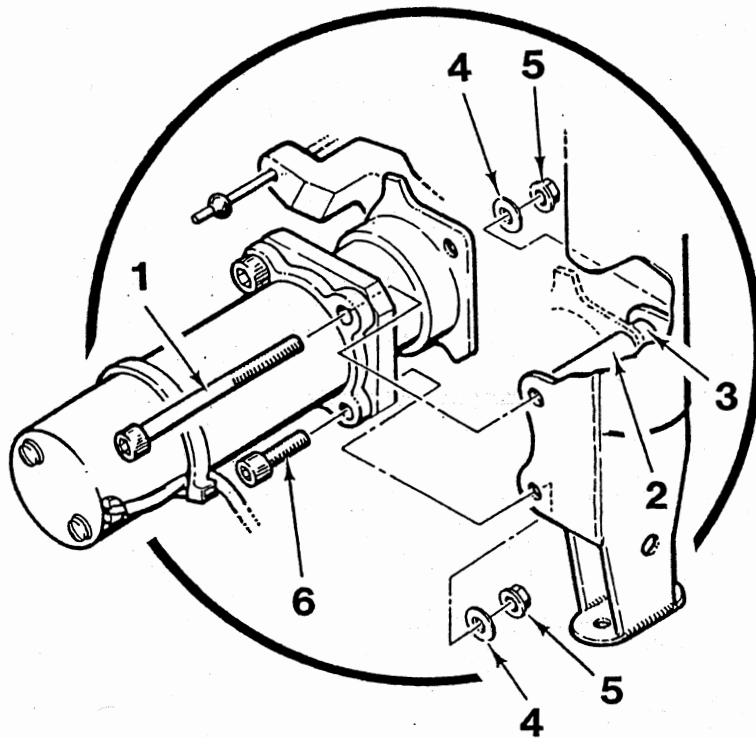

Item	Part number	Description
1	NAS1352-08-32P	Screw
2	C130-11	Spacer
3	C130-20	Spacer
4	NAS620-8L	Washer
5	MS21042L08	Nut
6	NAS1352-08-12P	Screw