

### KI-208-1 / KI-208-2 R66 Placards and Markings Kit Instructions

*For compliance with R66 Service Bulletin SB-02*

#### NOTE

Visit [www.robinsonheli.com](http://www.robinsonheli.com) to verify kit instructions are current revision. Review instructions before installation; contact RHC Technical Support with questions. Verify kit contents match list; contact RHC Customer Service if parts are missing or damaged.

ITEM NUMBER	PART NUMBER	DESCRIPTION	QTY PER KI-208-1	QTY PER KI-208-2
<b>KIT CONTENTS</b>				
1	KI-208 INSTR.	Kit Instructions . . . . .	1	1
2	A654-94	Decal - "DANGER HOT EXHAUST" . . . . .	2	2
3	D819-3	Decal (Face assembly; fuel quantity) . . . . .	1	0
4	D819-4	Decal (Cyclic cover; minimum solo pilot weight) . . . . .	1	0
5	F654-3	Decal - "ENGINE OIL" . . . . .	1	0
6	F654-4	Decal - "NEVER EXCEED SPEED" . . . . .	1	1
7	F654-7	Decal - "CAUTION" (Baggage compartment loading) . . . . .	1	0
8	F654-10	Decal - "CAUTION" (Seat compartment loading) . . . . .	4	0
9	MT699-1	Pilot's Checklist . . . . .	1	1

#### CAUTION

Verify surfaces are clean and dry before attaching decals. Use a clean cloth wet with acetone or mild soapy water to clean surfaces, but use caution when using acetone near silk-screened lettering. Acetone can smudge or remove silk-screened letters.

#### **KI-208-1 Kit Instructions**

1. Refer to Figure 1, item 1 and Figure 2. Attach D819-3 decal to B051-20 face assembly as shown.
2. Refer to Figure 1, item 2 and Figure 3. Attach D819-4 decal to F444-1 cyclic cover as shown.
3. Refer to Figure 1, item 3 (4 places). In seat compartments, note locations and remove F654-10 revision F (or prior) decals. Attach F654-10 revision G (or subsequent) decals at same locations.
4. Refer to Figure 1, item 4. On oil tank, note location and remove F654-3 revision F (or prior) decal. Attach F654-3 revision G (or subsequent) decal at same location.

**KI-208-1 Kit Instructions (continued)**

5. Refer to Figure 1, item 5. On baggage compartment door, note location and remove F654-7 revision F (or prior) decal. Attach F654-7 revision G (or subsequent) decal at same location.
6. Perform KI-208-2 kit instructions.

**KI-208-2 Kit Instructions**

1. Replace helicopter's plastic-laminated MT699-1 Pilot's Checklist with Aug 11 revision (or subsequent).
2. Refer to Figure 1, item 6 (2 places). Unless previously installed, attach A654-94 decals to tailcone as shown.

**CAUTION**

Use caution when using acetone to clean airspeed placard assembly. Do not allow acetone to contact silk-screened lettering on cyclic stick assembly, or nylon collars on either side of rotatable tube.

3. Refer to Figure 1, item 7. Remove F654-4 revision H (or prior) decal. Center, straighten, and attach F654-4 revision I (or subsequent) decal to rotatable tube, bottom to top.
4. Using a razor blade, trim decal flush with ends of tube without damaging nylon collars. Touch-up decal trimmed edges with black permanent ink, as required.
5. Make appropriate maintenance record entries.

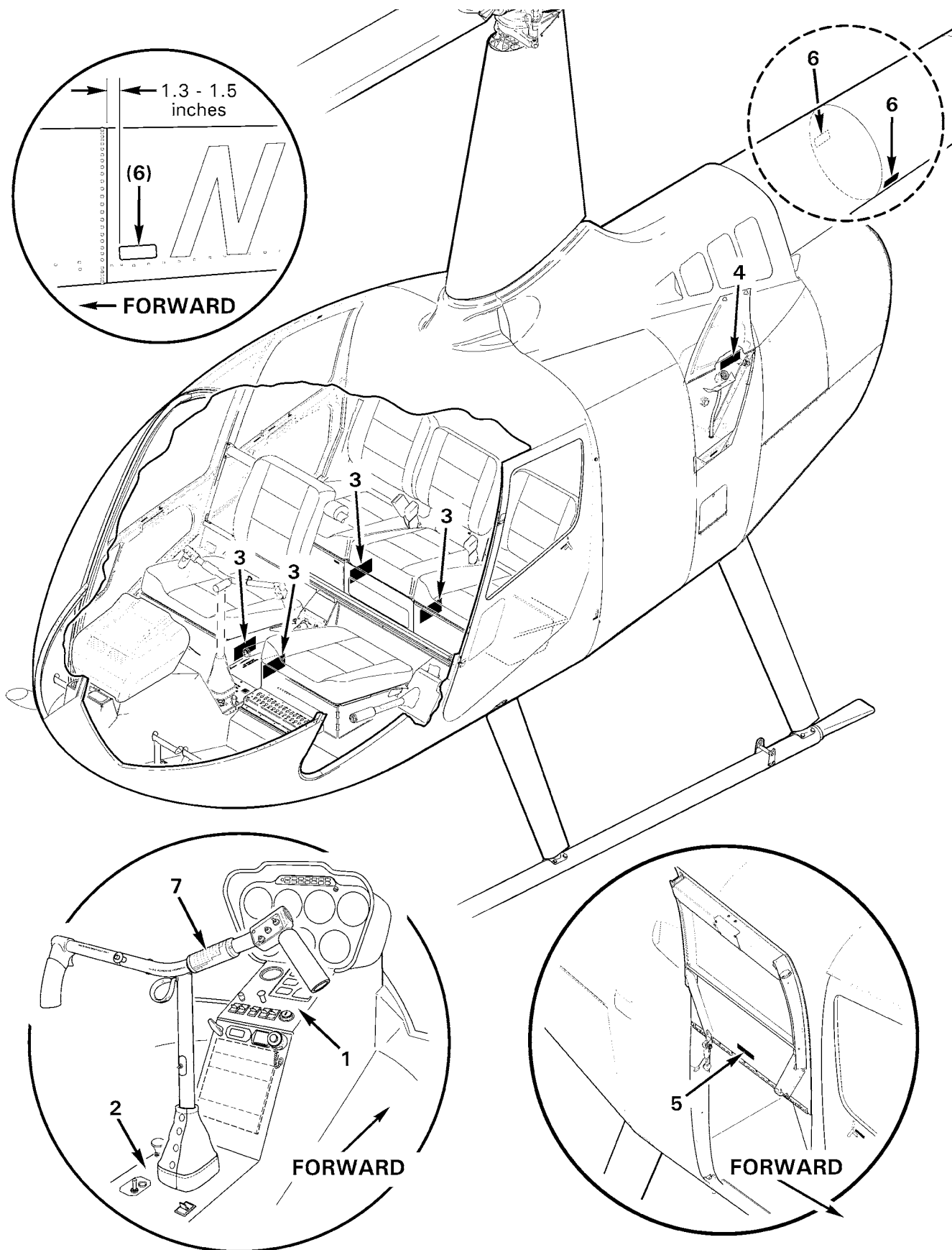
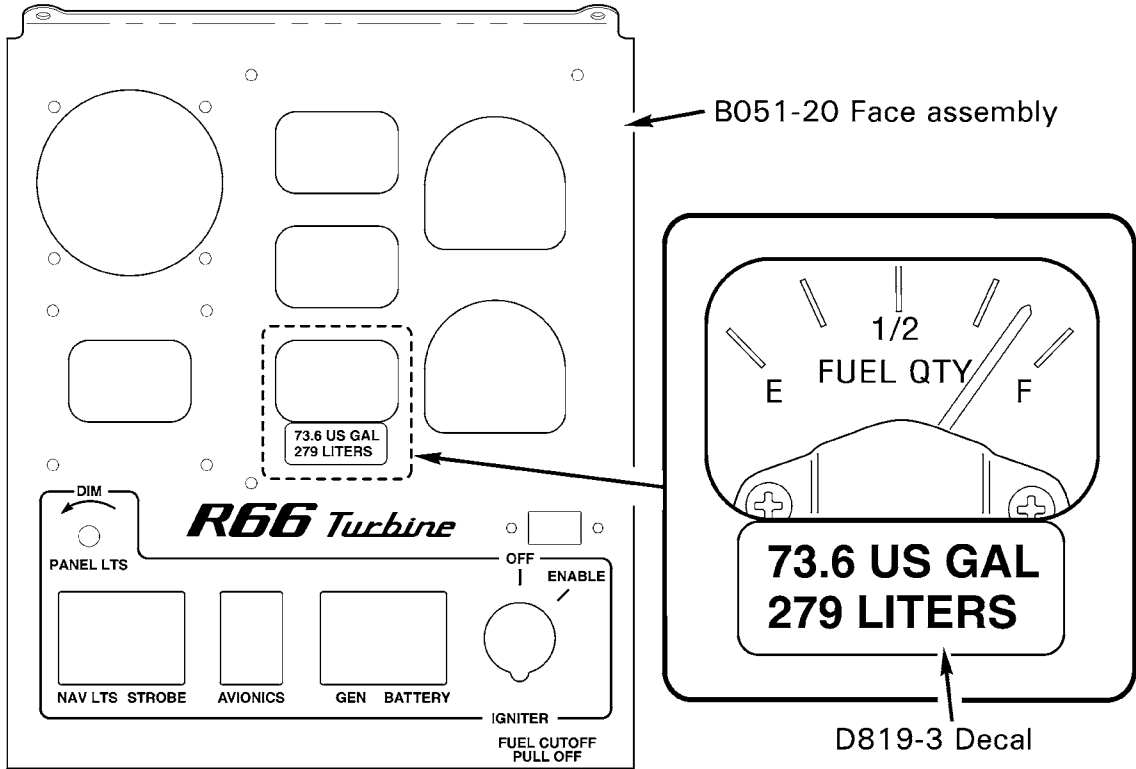
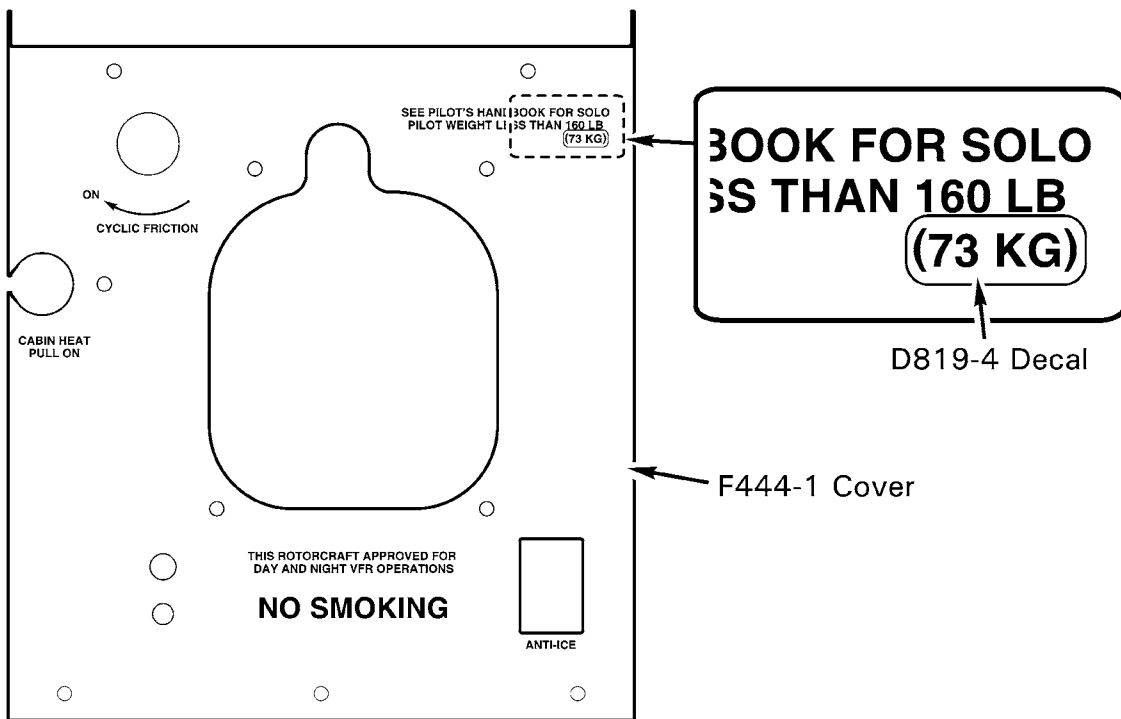

FIGURE 1



**FIGURE 2**



**FIGURE 3**